



GEMILANG SQUARE



KULAI

FREEHOLD



THE **NEW**
COMMERCIAL
HOTSPOT
OF **KULAI**
古来热门商业新焦点!

A VIBRANT COMMERCIAL SPACE THAT OFFERS BEYOND BUSINESSES
衔接商业店铺的停车场宽敞无比，提供充足的停车位，让源源不绝的消费者轻易取得停车位。

Be part of Kulai's fast growing district and unleash the potential of your business in Gemilang Square to enjoy the high investment returns and excellent capital appreciation.

Gemilang Square's shop offices are the perfect setting for wide-variety of business needs that include signature offices, established retail outlets, convenience stores, restaurants, fine dining, tuition centres, service providers, clothing & fashion boutiques, pharmacy and many more.

Located within the booming Kulai township, Gemilang Square offers an excellent visibility and accessibility which allows maximum exposure for steady customer flow.

PLACE YOUR BUSINESS IN A MATURED RAPIDLY GROWING TOWNSHIP

将您的生意设立在迅速及稳健发展的城镇，必定一本万利！

MATURED
RESIDENTIALS

JOHOR
PREMIUM OUTLETS®
A GENTING SIMON CENTER

FOON YEW HIGH
SCHOOL KULAI

i-PARK
INDAHPURA

INDAHPURA
INDUSTRIAL PARK

SME CITY

AEON MALL
KULAI

SPORT CITY
INDAHPURA

PERSIARAN INDAH PURA UTAMA



PERSIARAN INDAH PURA 2

GREAT LOCATION ADDS GREAT ADVANTAGE

绝佳的地点造就绝对的成功优势

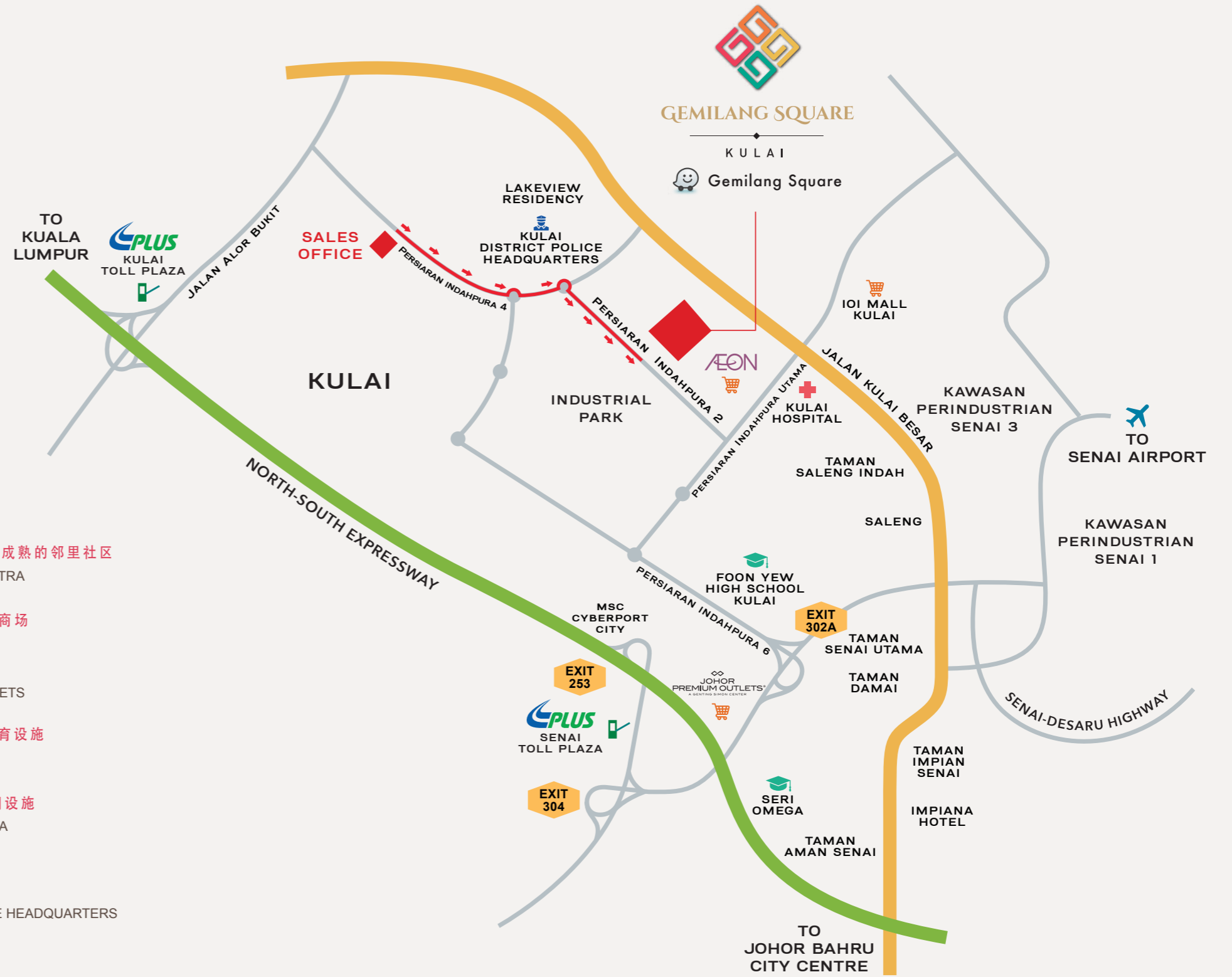
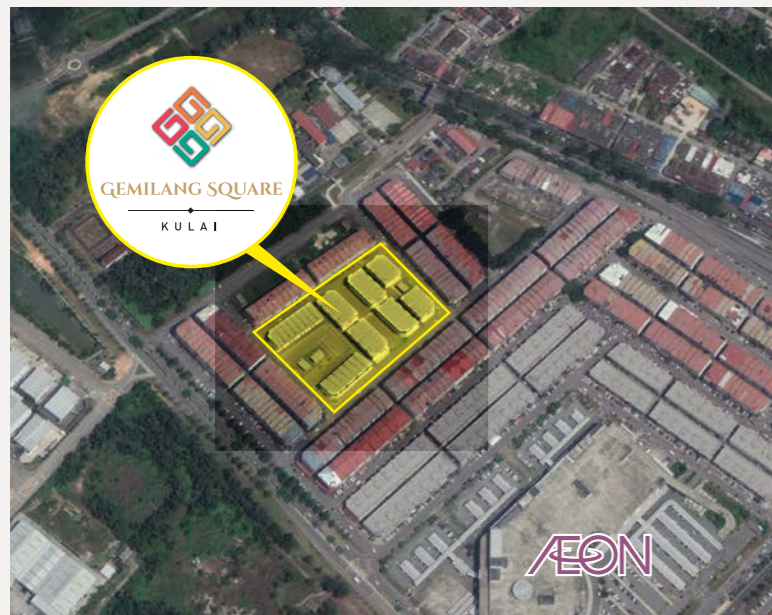

- MATURED NEIGHBOURHOOD** 成熟的邻里社区
 GENTING INDAHPURA, BANDAR PUTRA
- SHOPPING MALLS** 知名的购物商场
 2 MINS AEON KULAI
 7 MINS IOI MALL KULAI
 8 MINS JOHOR PREMIUM OUTLETS
- EDUCATIONAL AMENITIES** 教育设施
 6 MINS FOON YEW KULAI
- LEISURE & SPORTS** 运动与休闲设施
 3 MINS SPORT CITY INDAHPURA
- OTHER AMENITIES** 其他设施
 5 MINS KULAI HOSPITAL
 6 MINS KULAI DISTRICT POLICE HEADQUARTERS

i-Park Indahpura



SME City



Sport City Indahpura



Johor Premium Outlets



AEON Kulai



PRIME ADDRESS FOR SUCCESSFUL
BUSINESS AND OPTIMAL GROWTH
黄金商业店铺，将您的生意推向另一个高峰！



Artist's Impression Only



Gemilang Square presents a fabulous collection of modern 2 storey shop offices within a strategic location. Uniquely catering to every business need, Gemilang Square fuses a contemporary facade with superior infrastructure.

The "Main Street" will be the center of attention of Gemilang Square as it creates a sense of welcoming to the visitors as well as ensuring the smoothness of traffic flow.

位于古来市最繁华的地区，Gemilang Square地处最佳的策略性地理位置，加上卓越的交通网，摩登时尚的建筑设计，客源流量的稳定，必定会为此区的商业活动带来旺盛的新气象。



Artist's Impression Only

BUILT FOR TODAY'S MODERN BUSINESS IN MIND



现代化的店铺设计，适合各类现今及未来的生意运营模式。
TO LET YOUR BUSINESS EXCEL, WE ADDED VERSATILITY

Gemilang Square features 8 exclusive units of shop offices with the 18ft area of covered-balcony design which are available for more creative and diverse business setting.





The limited units adjacent to the pedestrian walk are highly visible to the crowd which make your investment to be even more rewarding and appealing.



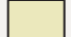

SITE PLAN

LEGEND:

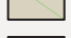
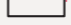
	Type A Corner Unit (Built-up 24' x 70')	8 units
	Type B Intermediate Unit (22' x 70')	19 units
	Type C Intermediate Unit (20' x 70')	6 units
	Type D End Unit With 10' Extra Land (Built-up 24' x 70')	4 units
	Type E End Unit (22' x 70')	2 units
	Type F End Unit (20' x 70')	2 units
	Type G Signature Unit With Balcony (22' x 70')	8 units

Total : 49 units



- More than 250 car park lots
- Directly link to commercial units for convenient access



2 STOREY SHOP OFFICE

Corner Unit

Type A Built-up : 24' X 70'

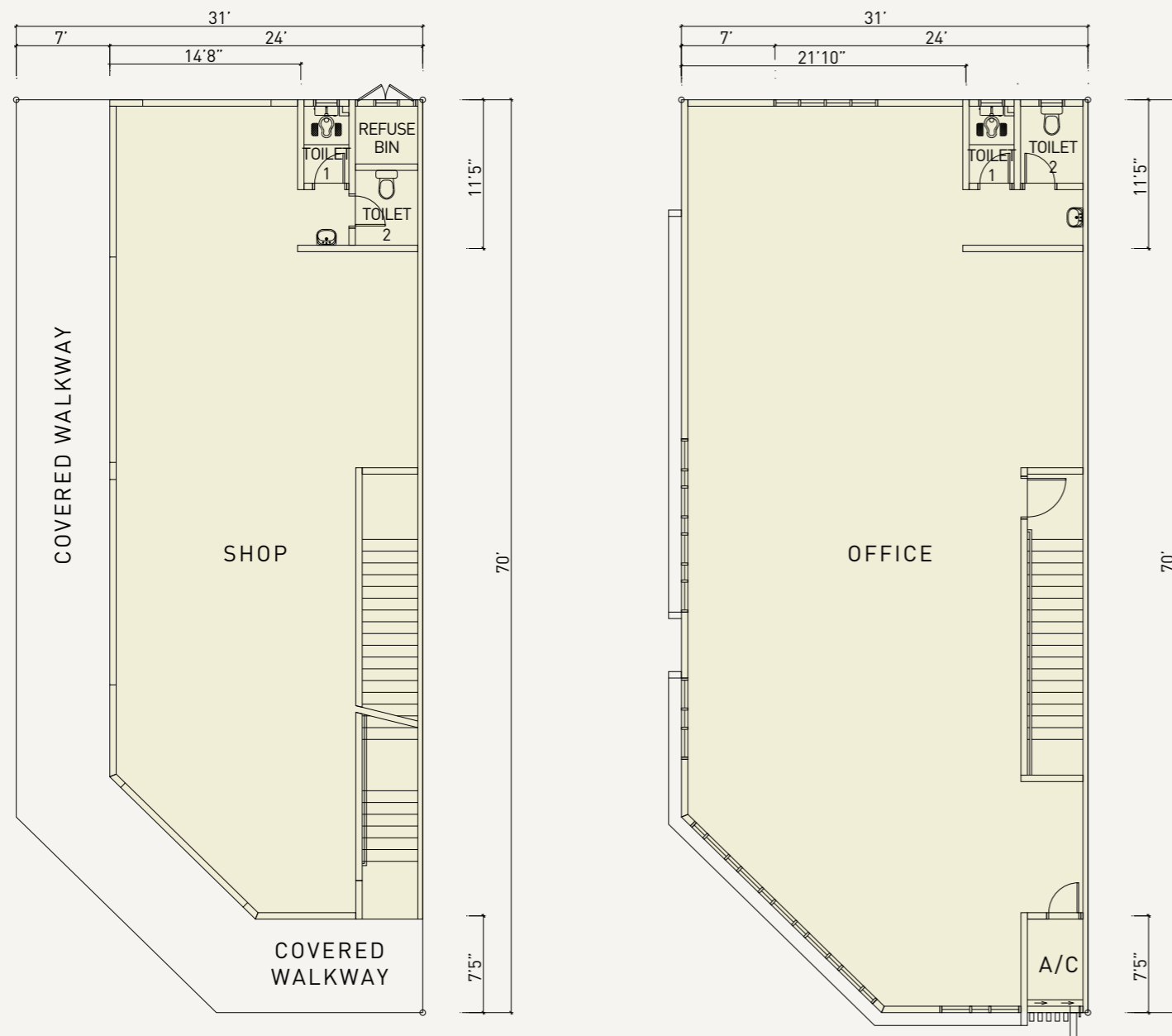

GROUND FLOOR PLAN

FIRST FLOOR PLAN

2 STOREY SHOP OFFICE

Intermediate Unit

Type B : 22' X 70'

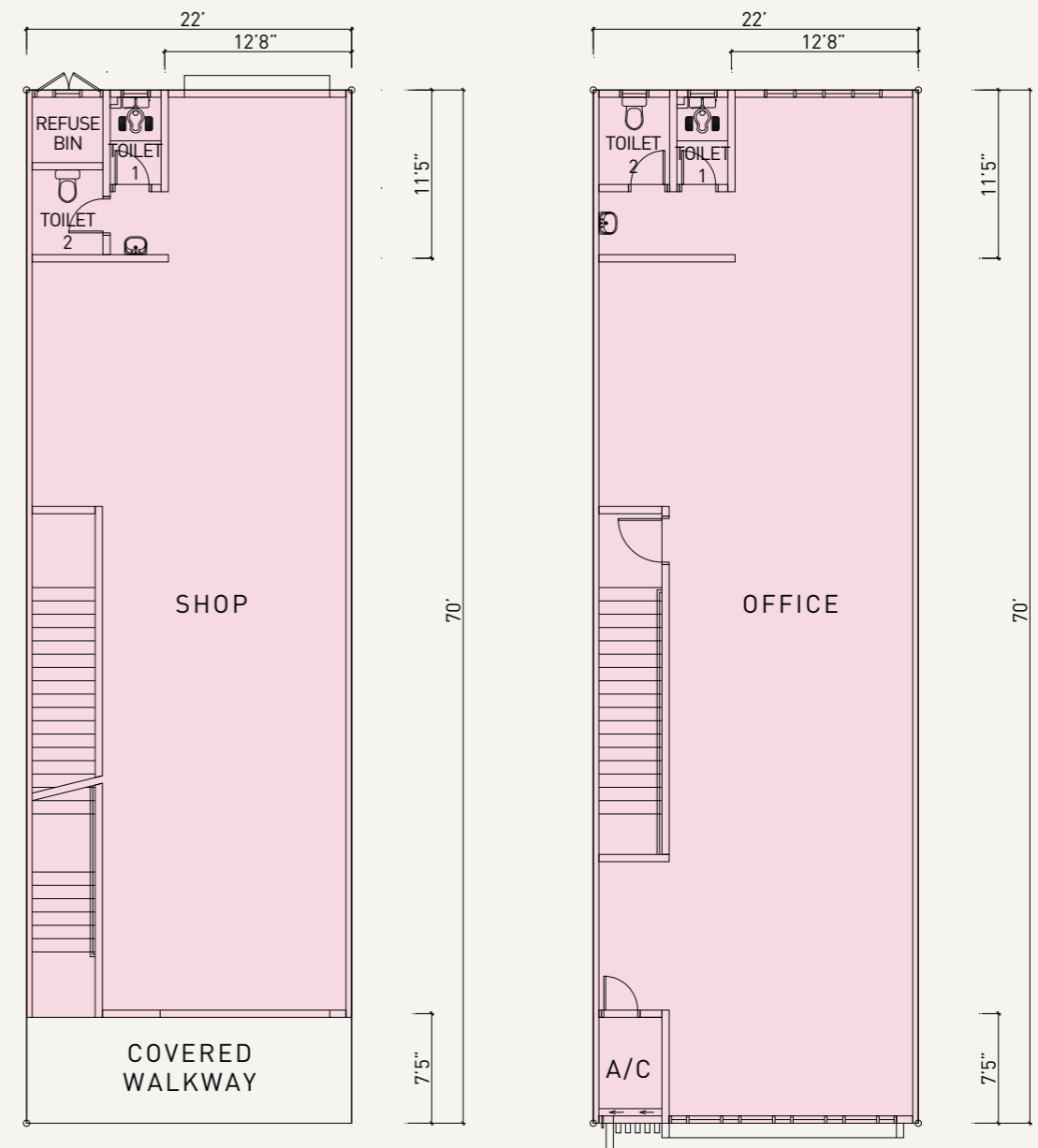

GROUND FLOOR PLAN

FIRST FLOOR PLAN

2 STOREY SHOP OFFICE

End Unit

Type D Built-up : 24' X 70' (Extra Land 10')

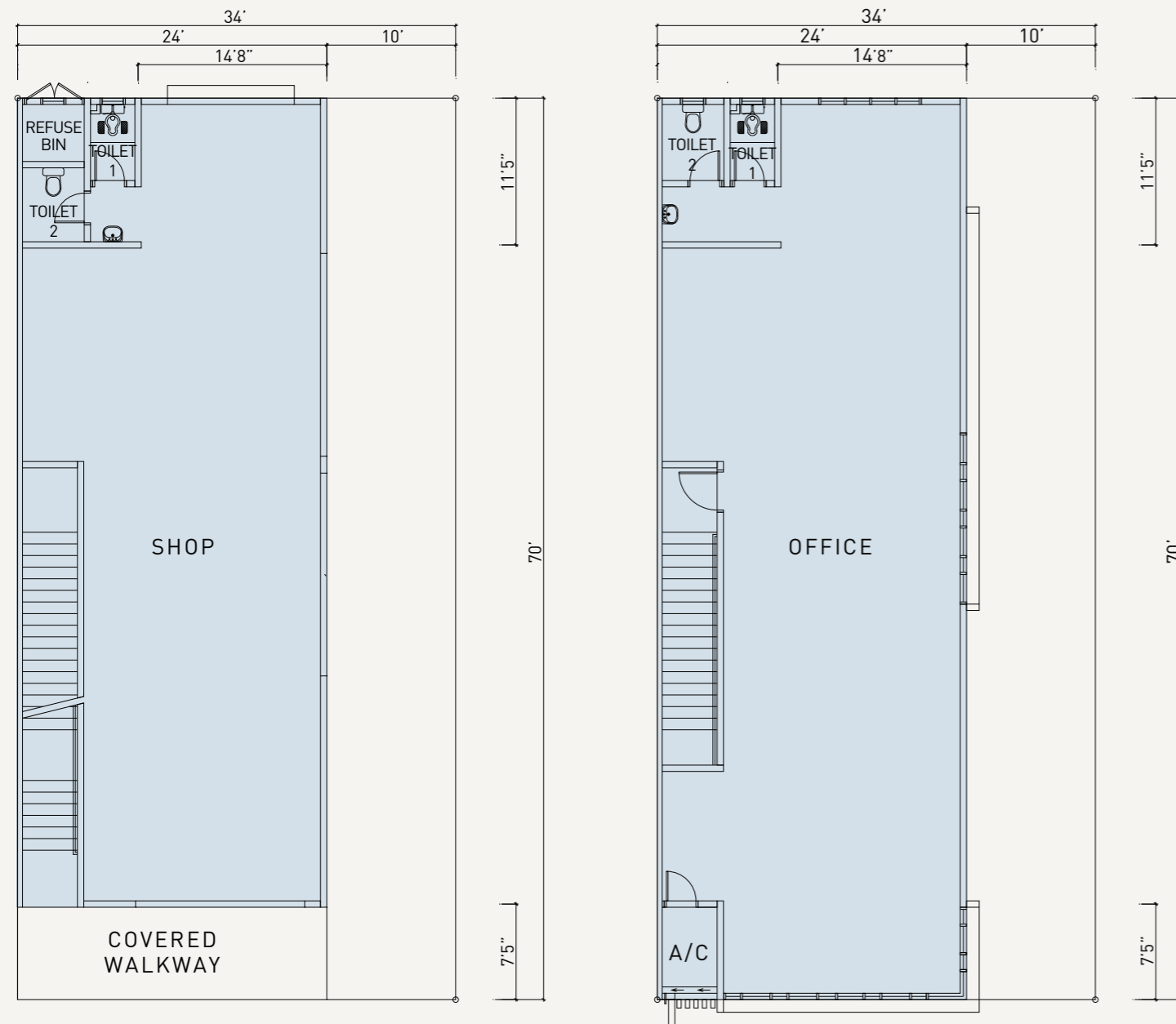

GROUND FLOOR PLAN

FIRST FLOOR PLAN

2 STOREY SHOP OFFICE

Signature Unit (Balcony)

Type G : 22' X 70'

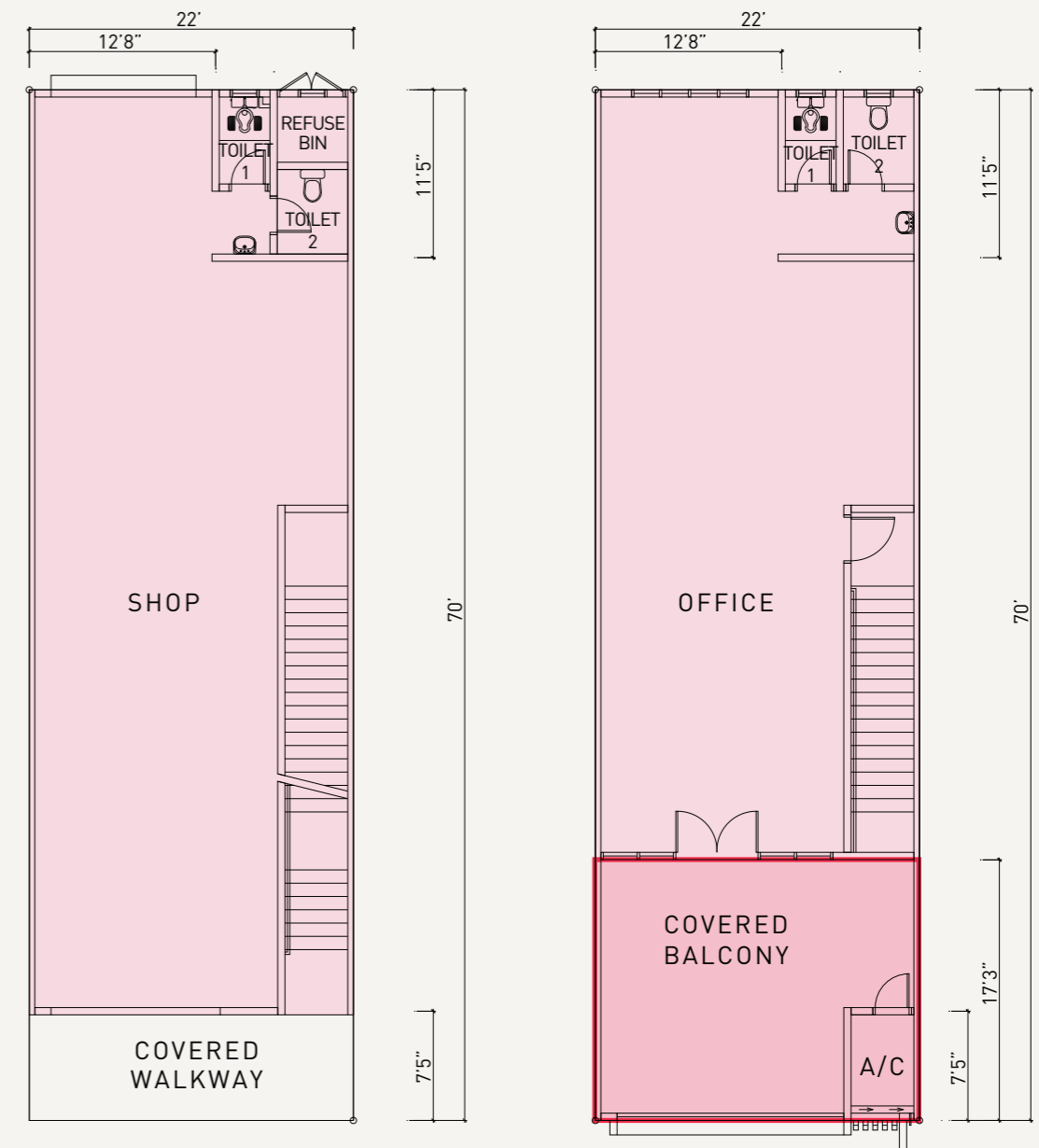

GROUND FLOOR PLAN

FIRST FLOOR PLAN

KCC REALTY

Building Value For Life

Wangsa Optima Sdn. Bhd. (199601011629)

Headquarters : 93, Jalan Hashim, 84000 Muar, Johor, Malaysia

Fax : +606-952 9557 QuickLink : +606-953 3399

Kulai Sales Gallery : 86, Jalan Gangsa 1, Taman Gemilang, 81000 Kulai, Johor.

Tel : +607-662 5166 Email : kulai.sales@kcc-realty.com

017-6886 229

012-6886 292

 KCCRealty1983

www.kcc-realty.com

ISO 9001:2015
PROVISION OF PROPERTY DEVELOPMENT SERVICES



All plans, information and specification contained herein are subject to change and / or amendments as directed by the relevant authorities / architects and cannot form any part of an offer and contract. All measurements are approximate and the illustrations are artist's impressions only. While every reasonable care has been taken in preparing this brochure, the developer cannot be held responsible for any inaccuracies.