

# the Tresor

@ G R A V I T 8

PARKHOMES • RESIDENCES • RETAIL

---

FREEHOLD





# ENJOY, ENDEAVOUR, *experience*

the **Tresor**  
GRAVITY

PIER8

Nestled within 15 acres of freehold land, Gravit8 is thoughtfully designed as an exciting 360° self-sustaining lifestyle hub within Klang. Complete with a lifestyle mall, serviced residences, an office tower, a hotel and SOHO units, Gravit8 is where you will find a holistic lifestyle experience.





# SANTORINI BY THE *lake*

Discover Santorini's Cycladic architecture right here in Klang, where curved lines and brilliant blue accents, mirroring the undulating waves and cloudless skies, are brought to life.

This inspiration is brought forward throughout the residence's entire identity, from architecture to its holiday-styled lifestyle facilities. Enjoy the best of Santorini while facing a stunning 8-acre Lakepark, amid the vibrant masterplan of Gravit8.



THE  
MASTERPIECE OF  
*gravit8*

The Tresor @ Gravit8 is set in the masterplan's most impressive parcel, offering breathtaking views of the exquisite Lakepark. Wake up to unobstructed lakefront vistas and end the day with astonishing sunsets – this is a new standard of lakefront living.

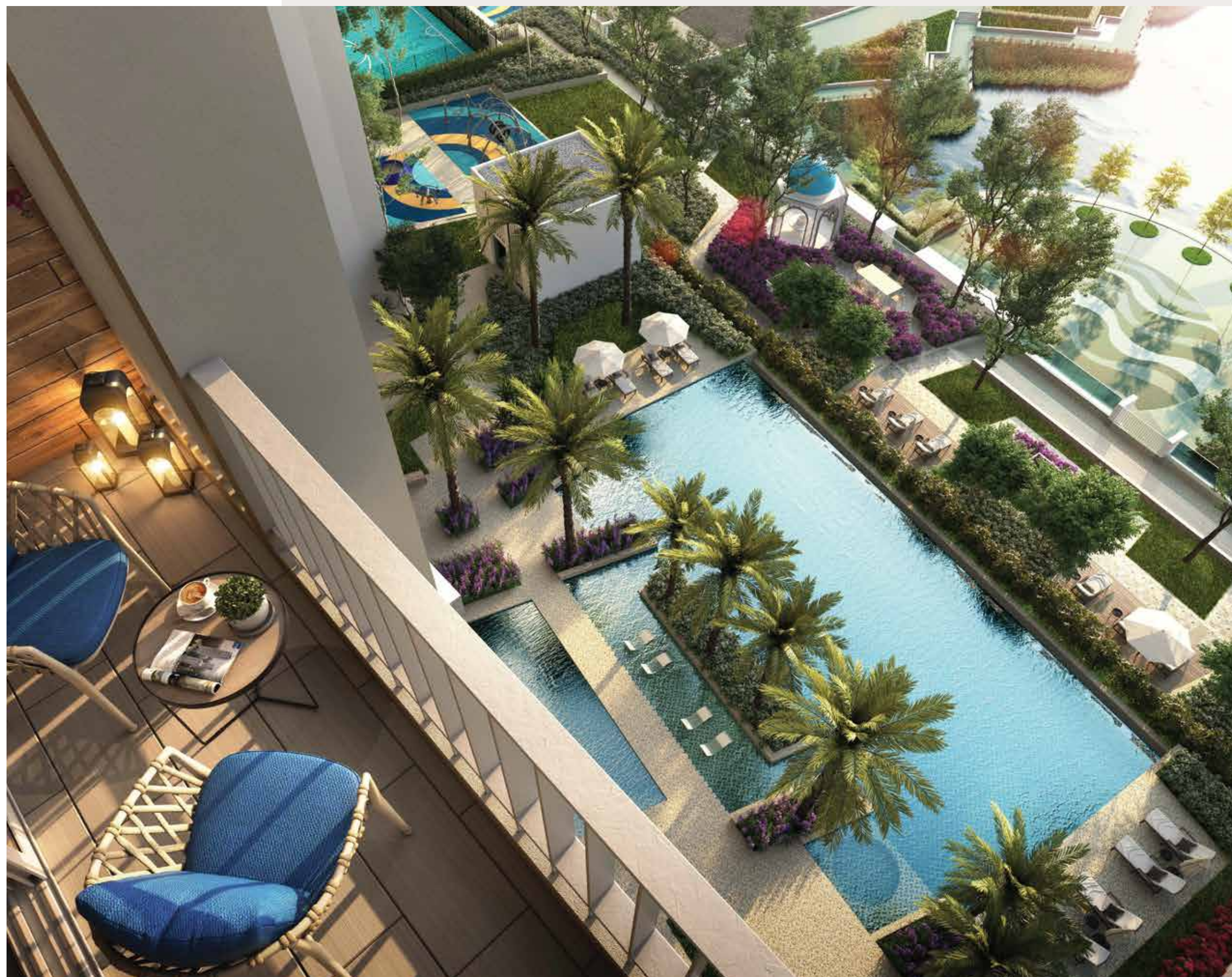





A WARM  
*welcome*  
HOME

An impressive drop-off lobby with sprawling white arches bring Santorini to you, while multi-tiered security offerings assure you and your family live well. A link bridge to Pier8 connects you directly to Klang Valley's first maritime-themed mall, where endless restaurants and lifestyle conveniences are just waiting to be discovered.



*island*

LIVING AT ITS BEST

Santorini is a destination of awe and wonder, and The Tresor @ Gravit8 captures this charm and translates it through extraordinary architecture and incredible landscaping. From Santorini's timeless bright blue domes to the lush plants of the island – every detail here has been carefully crafted to bring all the delights of Santorini to you.







## A HOLIDAY *every day*

Crafted for families, inspired by Santorini's natural beauty. Take a swim in an infinity edge pool, admire the sunset at the sunken deck, or spend carefree evenings at the cosy lounge area with your loved ones and neighbours. It's all just a day in the life at The Tresor @ Gravit8.





# THE FACILITY *plan*

- 01 Changing Rooms
- 02 Reading / Coworking Space
- 03 Multipurpose Hall

## ACTIVE ZONE

- 04 Gymnasium
- 05 Kids' Pool
- 06 Lap Pool
- 07 Party Terrace
- 08 Play Lawn
- 09 Playground
- 10 Fun Slide
- 11 Half Basketball Court
- 12 Exercise Station

## CHILL OUT ZONE

- 13 Open Lounge
- 14 Wading Pool
- 15 Jacuzzi
- 16 Pool Deck
- 17 Sun Deck
- 18 Hammock Area
- 19 Glow Bay
- 20 Bleu Arc
- 21 Sunset Terrace
- 22 Garden Path
- 23 Reflexology Path
- 24 Sensory Garden







DISCOVER  
YOUR PERFECT *home*

Three unique types offer three distinct experiences, all within one inspiring residence. Serviced Residences bestow awe-inspiring views, while the Garden Homes merge high-rise living with a private garden and landscaped greenery that surround you and your family. With the Parkhomes, residents can park their cars directly in front of their units, creating the seamless accessibility of a townhouse set within an apartment.





# LOCATION *map*

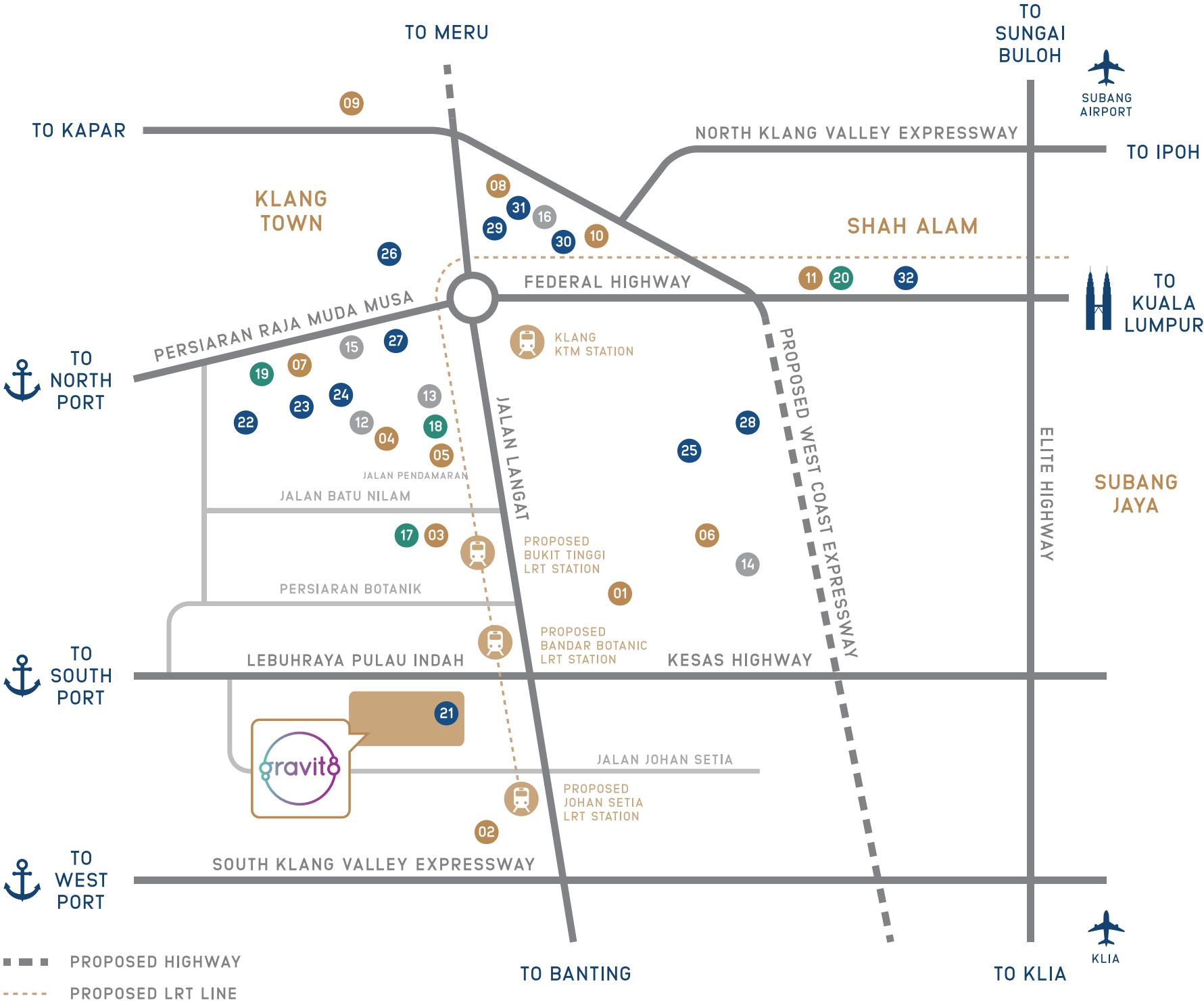

## ● RETAIL MALLS

01	GM Klang	(5.2KM)
02	KSL Esplanade Mall	(5.8KM)
03	AEON Mall Bukit Tinggi	(5.8KM)
04	Giant Hypermarket	(6.6KM)
05	Tesco Extra Bukit Tinggi	(6.9KM)
06	NSK Trade City	(8.5KM)
07	Harbour Place Mall	(10.0KM)
08	Klang Parade	(13.4KM)
09	AEON Big Klang	(15.2KM)
10	AEON Bukit Raja	(16.0KM)
11	Central i-City	(18.6KM)

## ● MEDICAL CENTRES

12	Manipal Hospitals Klang	(7.4KM)
13	Klang General Hospital	(7.9KM)
14	Sentosa Specialist Hospital	(8.9KM)
15	Pantai Hospital Klang	(9.7KM)
16	KPJ Klang Specialist Hospital	(14.0KM)

## ● HOTELS

17	The Canvas Hotel	(4.8KM)
18	Première Hotel	(6.4KM)
19	Crystal Crown Hotel	(7.1KM)
20	Best Western i-City	(17.8KM)

## ● EDUCATIONAL

21	Orbix International School	
22	SJK (C) Pandamaran A	(6.6KM)
23	SJK (C) Pandamaran B	(6.7KM)
24	SJK (C) Hin Hua	(7.7KM)
25	Zenith Private Schools Klang	(9.7KM)
26	SMK Methodist ACS	(10.6KM)
27	SMK La Salle	(10.6KM)
28	SMJK Chung Hwa	(11.9KM)
29	SMK Tinggi Klang	(12.0KM)
30	Sekolah Sri Acmar	(13.8KM)
31	Kwang Hua Private High School	(14.5KM)
32	UITM Shah Alam	(21.5KM)





# MITRALAND

Developer:  
Vibrantline Sdn. Bhd. (1038413-U)

D-28-01, Menara Mitraland, No.13A, Jalan PJU5/1,  
Kota Damansara PJU 5, 47810 Petaling Jaya, Selangor.  
[www.gravit8.com.my](http://www.gravit8.com.my) [www.mitraland.com.my](http://www.mitraland.com.my)

Sales Gallery Open Daily (10am - 6pm)  
For further enquiries, please call:

**011 - 1638 6882**  
**03 - 3323 7688**

Developer's License: 14308-3/01-2023/69(L) • Validity Period: 27/01/2021-26/01/2023 • Advertising & Sales Permit: 14308-3/01-2023/69(P) • Validity Period: 27/01/2021-26/01/2023 • Type of Property: Serviced Apartment • Approving Authority: Majlis Perbandaran Klang (MPK) • Building Plan Reference No: MPK/BGN-600-4/1/0113(2019) • Expected Completion Date: Feb 2025 • Land Tenure: Freehold • Land Encumbrances: Charged to Affin Bank Berhad • Total Units: The Tresor 374 Units (Type A/C/D/E), Mampu Milik 42 Units (Type B) • Minimum Price: RM567,648.00, Maximum Price: RM875,118.00 (The Tresor) • Minimum Price: RM270,000.00, Maximum Price: RM270,000.00 (Mampu Milik) • 7% Discount for Bumiputera • Restriction on Title: Nil • The information contained in the advertisement is subject to variations, modifications and substitutions as may be recommended by the relevant authorities and/or the project architect and cannot form part of an offer or contract. It shall not constitute and/or be treated as an offer on the part of the developer. All the information in this advertisement is current at the time of printing. All renderings are artist impressions only and all measurement are approximate.

THIS AD IS APPROVED BY THE NATIONAL HOUSING DEPARTMENT