

RAWANG'S 1st RIVERFRONT LIVING LIFESTYLE CONDOMINIUM

PRICE
FROM **RM360k**

- **ONLY RM1,000 BOOKING FEE**
- **RM60K CASH BACK**
- **24-HR GUARDED & GATED
NEIGHBOURHOOD**
- **FREE 2-3 CAR PARKS**
- **FREE S&P LOAN FEES**
- **830sqft - 1565sqft**



**BOOK NOW & FREE
IPHONE8**

丽晶苑
**LEGEND
VIEW**
RIVERFRONT RESIDENCES





LEGENDVIEW

A Property Considers Social & Environmental Impacts!
 Legendview is strategically located, giving its residents the perfect start to a new life. Popular destinations including shopping malls namely AEON Rawang, TESCO Rawang, Forest Parks such as Air Terjun Taman Rimba Komanwel and Taman Eko Rimba Kanching are accessible within minutes, which add more colorful dimensions to an urban living. This green - conscious development encases lush greenery via the natural jungle, gardens as well as green pockets.

FACILITIES

- Nursery kindergarden
- Basketball court
- Multipurpose hall
- Squash court
- BBQ facility
- Surau

- Sky deck
- Wading pool
- Mini Mart
- Cafeteria
- Laundry
- Jogging Track

- Gymnasium

- Children playground



- Swimming pool



- Sky deck



PROJECT SUMMARY

690
EXCLUSIVE
UNITS

5 STAR
FACILITIES

SKY DECK
WITH
GENTING
VIEW

PRIVATE
JOGGING
TRACK



Developer :

Legendview Housing
Development Sdn Bhd

Project :

3 Blocks 690 Units Exclusive
Condominium Apartments

- Block A & B - 6 Stories Podium
Car Park
- Block C - 5 Stories Podium Car
Park
- Every units comes with 2 cover
parking bay
- Unit with size more than
1400sf and Penthouse unit
would have 3 parking bays

Location :

Jalan Setia Jaya, Selangor
Located at Rawang (near to
Tesco Rawang)



Land Area :

5.35 acres / 233,046 sqft

Land Title : Residential

Tenure : Leasehold

No. of Block : 3 Blocks

- Block A - 21 Storey - 210 units
- Block B - 22 Storey - 240 units
- Block C - 22 Storey - 240 units

GPS Coordinate

Land Area :
5.35 acres / 233,046 sqft

No. of Storeys : 22

Estimated Completion Date:
First quarter of 2019

FLOOR PLAN

TYPE A - 830 sqft

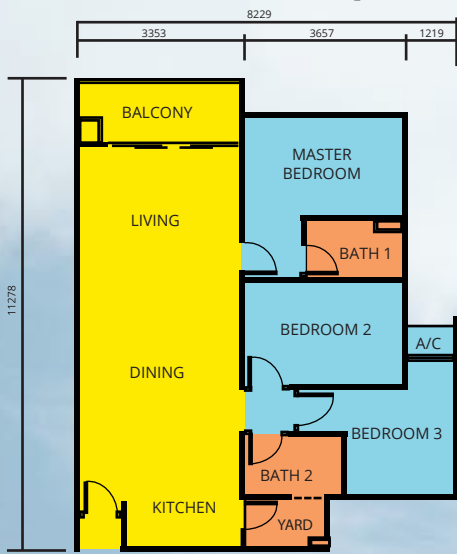

TYPE B - 1029 sqft

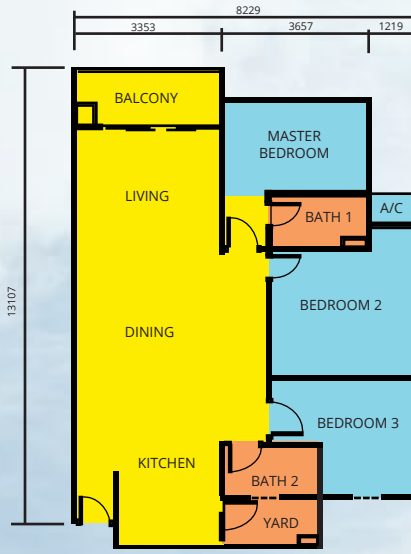

TYPE C - 1212 sqft

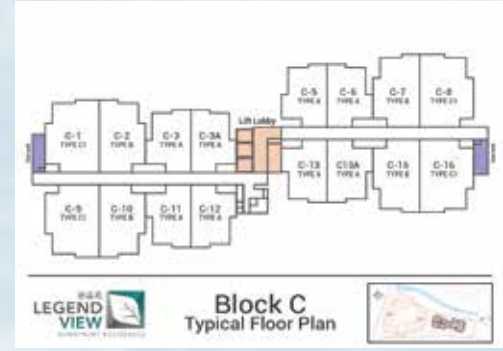
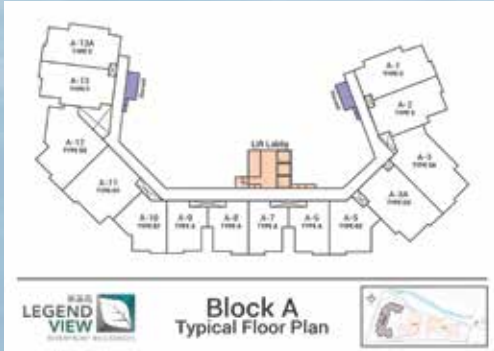
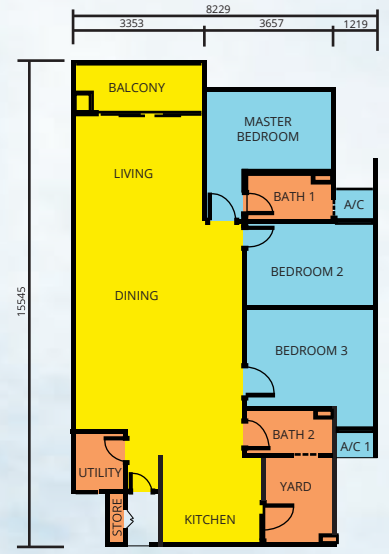

ACTUAL SHOW UNIT



ACTUAL SHOW UNIT

HIGHWAY

Kuchai Lama to Legendview - Lebuhraya Kuala Lumpur to Seremban **35km 33mins**

KLCC to Legendview - Jalan Kuching **25.5km 30mins**

KLIA to Legendview - Elite Highway **82.1km 1hr**

Selayang to Legendview - Jalan Rawang **9.1km 12mins**

Legendview to Genting Highlands - Lebuhraya K.L (Gua Musang) **56.8km 1hr**

Sungai Buloh to Legendview - Lebuhraya KL **22.8km 28mins**

Kepong to Legendview - Lebuhraya Kepong to Selayang **15.9km 23mins**

SHOPPING MALLS, RETAIL SHOPS & HOSPITALS

 **TESCO** 100m

 **AEON** 9.6km

 **Giant** 5km

 **PARKSON** 4.2km

 **SURIA KLCC** 25.5km

 **BERJAYA TIMES SQUARE KUALA LUMPUR** 27.3km

 **99 SPEEDMART** 2km

 **7 ELEVEN** 2.6km

 **KPJ HEALTHCARE** 4km

 **KAMI SEDIA MEMBAHU** 4.6km

ACCESSIBILITY

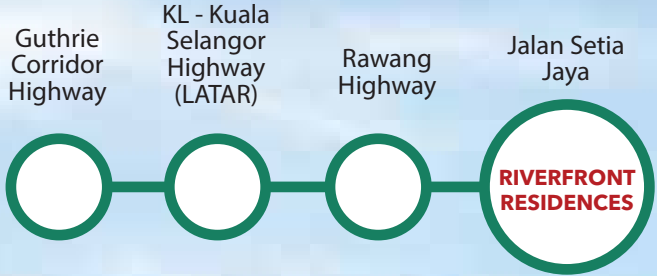
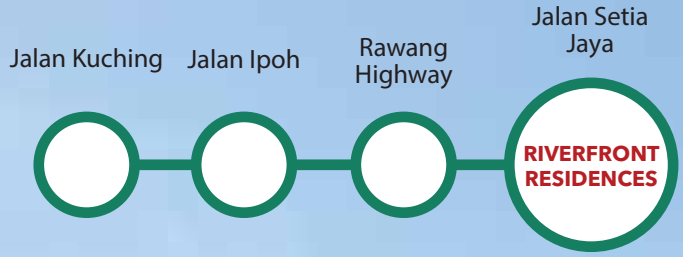

LOCATION MAP



For enquires, please contact :



Legendview sales gallery
 15A, Jalan SJ 1, Taman Setia Jaya,
 Rawang, Selangor 48000



Pemaju:
Legendview Housing Development Sdn Bhd
 C-8-29, Centum @ Oasis Corporate Park, No.2, Jalan PJU
 1A/2, Oasis Damansara, 47301 Petaling Jaya, Selangor

• No. of Units: 690 • Type: Condominium • Developer: Legendview Housing Development Sdn Bhd (976222-W) • Developer License No: 13803-1/01-2019/01041(L) • Validity Period: 12/01/2018 - 11/01/2019
 • Advertising & Sales Permit No: 13803-1/01-2019/01041(P) • Building Plan No.: MPS.3/2 - 1371/1472 (OCS) PB(A) • Building Plan Approving Authority: Majlis Perbandaran Selayang • Land Tenure: Leasehold 99 years (expiring 30/1/2096) • Encumbrances: NIL • Expected Date of Completion: 1st Quarter 2019 • Authority Approved Selling Price: RM273,240 (Min) - RM944,600 (Max) • Bumiputra Discount: 7%